

# IES1204P-SFP

## Industrial Ethernet Switch

4x10/100Base-TX(PoE) to 2x100Base-FX



### Overview

The IES1204P-SFP Industrial POE Switch is the ideal solution for powering remote devices such as IP phones, video cameras, wireless access points, alarms, traffic controllers, sensors and tracking devices, which are installed 100m far from a Power over Ethernet switch. In addition to transmitting data, the twisted-pair port also injects power down the cable, allowing a remote Power over Ethernet Device to operate without the need of any additional power source. All Power over Ethernet Powered Devices (IEEE 802.3af/at compliant) are supported, as the Power Sourcing Equipment (PSE) device can deliver a full 15.4W / 30W of power to the remote PD device.

The IES1204P-SFP features 2 x 100Base-X SFP Slot and 4 x 10/100Base-TX twisted-pair port. The IES1204P-SFP provides two SFP slot for any MSA-compliant pluggable 155M SFP transceivers. The twisted-pair port has 4 x RJ-45 connector with a maximum operating distance of 100m.

The IES1204P-SFP Industrial Ethernet Switch is designed to stand up to extreme temperature, surges, vibrations, and shocks found in industrial automation, government, military, oil & gas, mining and outdoor applications, such as traffic management, oil and gas pipelines.

The IES1204P-SFP series enables real-time deterministic network operation, requires no configuration and will instantly operate as soon as you power it up. Additionally, they can be installed by DIN-rail or wall-mounted, allowing users to deploy any mix of network conversions required.

### Features

- Provide 4 x 10/100Base-T(X)
- 2 x 100Base-X SFP Slot for Daisy-Chain
- IEEE802.3af/at compliant
- RJ45 support auto MDI/MDI-X function
- Auto-negotiation speed, half/full-duplex
- Store-and-forward

- Max packet size: 2048bytes
- Support wide operating temperature (-40 °C ~ +85 °C)
- Wide-range redundant power design (48~56VDC)
- Power polarity reverse protect
- Overload current resettable fuse present
- IP-40 protection
- Provides EFT protection for Power line
- Support Ethernet ESD protection
- DIN-Rail and Wall-Mounted Installation
- Low power consumption

## Applications

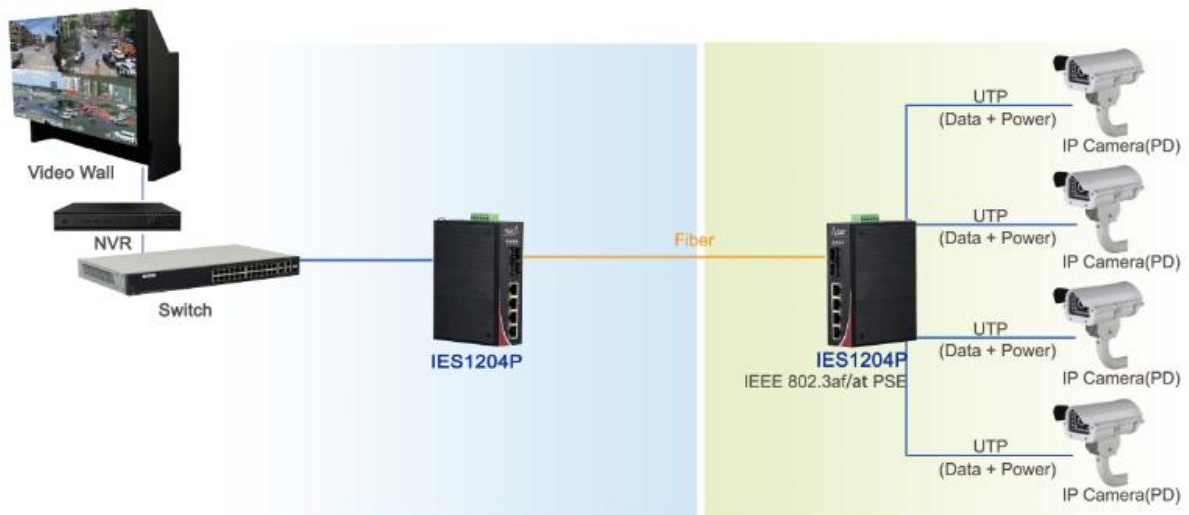

## Technical Specifications

Standards	IEEE802.3 10BaseT IEEE802.3u 100BaseT(X) IEEE802.3x Flow control and back pressure IEEE802.1d Spanning Tree IEEE802.3af/at POE
Performance	Processing Type : Store and Forward Back Bandwidth: 1.2Gbps MAC Address Size: 1024bit Packet Buffer Size: 512Kbit Time Delay: <10us Frame: 2048bytes
Copper Port	Data Rate: 10/100M Connector: RJ45 x 4 Distance: 100m
Fiber Port	Data Rate: 155M Connector: SFP slot x 2 Distance: Up to SFP Transceivers
LED indicators	PWR1: ON=Power Connected PWR2: ON= Power Connected FL/A: ON=Fiber Connected; Active=Data Transmitting L/A: ON=Copper Connected; Active= Data Transmitting POE: ON=POE Working; Off=No POE
Power	Input Voltage: 48~56VDC, redundant power inputs Power Consumption: ≤6W PoE Budget: 15.4Wx4=62W(PoE) 30Wx4=120W(PoE+) Protection: Overload Current; Reverse Polarity Connector: Terminal Block
Environment	Operating Temperature: -40 °C ~ +85 °C Storage Temperature: -40 °C ~ +95 °C Relative humidity: 5-95% (no condensation)
Physical Characteristics	Housing: IP40 Protection, Aluminum Alloy Installation: DIN-rail mounting, wall mounting(with optional kit) Dimension: 138*107*45mm(device); 220*175*73mm(packing) Weight: 0.48kg(device); 0.63kg(device with packing)

## Order Information

Model	Description
IES1204P-SFP	10/100M 2FX4FE PoE, SFP Slot
Note: AC/DC power supply purchased separately	

## Related Products

Model	Description
DIN-rail Power supply	
NDR-120-48	DIN-rail 120W, 90~264Vac input, 48~55Vdc output
SFP Module	
SFP-M1513L-02I	155M MM 1310nm LC 2km DDM, Industrial Grade
SFP-S1513L-20I	155M SM 1310nm LC 20km DDM, Industrial Grade
SFP-S1535L-20I	155M SM TX1310/RX1550nm LC 20km DDM, Industrial Grade
SFP-S1553L-20I	155M SM TX1550/RX1310nm LC 20km DDM, Industrial Grade
Long distance 40/60/80/100/120km is available	
Installation Accessories	
TK12	Wall-mounted kits, 118*18*16mm, $\phi$ 3.5mm L=12mm
A02	Side DIN-rail mounted kits, 72.7*70*8.5mm, $\phi$ 3.5mm L=6mm
CK01	Rack-mounted bracket with Din-rail, 483*215*130mm



TK12 Wall-mounted kits



A02 Side DIN rail mounted kits



CK01 Rack-mounted bracket

**Structure diagram (mm)**

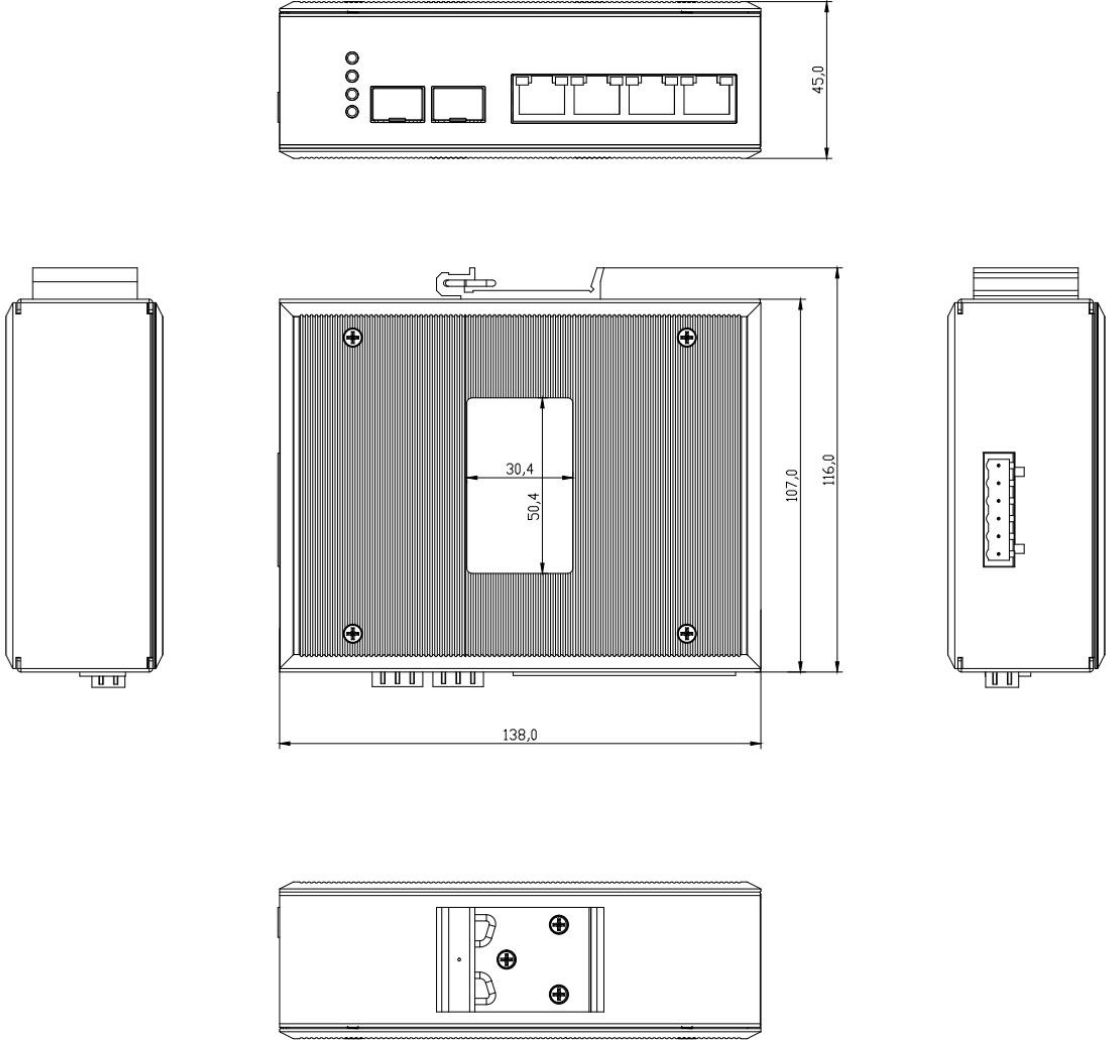

For further information, please visit our website <https://www.aoatech.com>  
All rights are reserved by AOA Technology Co.,Ltd. AOA reserves the right to change, modify, transfer, or otherwise revise this publication without notice, and the most current version of the publication shall be applicable.